

*The white cloth and loincloth are loaned items, so if they become soiled or damaged, we will charge you the actual cost. Also, please do not take them home without permission.

*If there are two or more booths, there will be no partition panels between them.

*As a general rule, side panels are not provided for corner booths (aisleside). Exhibitors who require side panels must fill in the box on the attached "Application Form for Electrical Works". We cannot accommodate requests on the day.

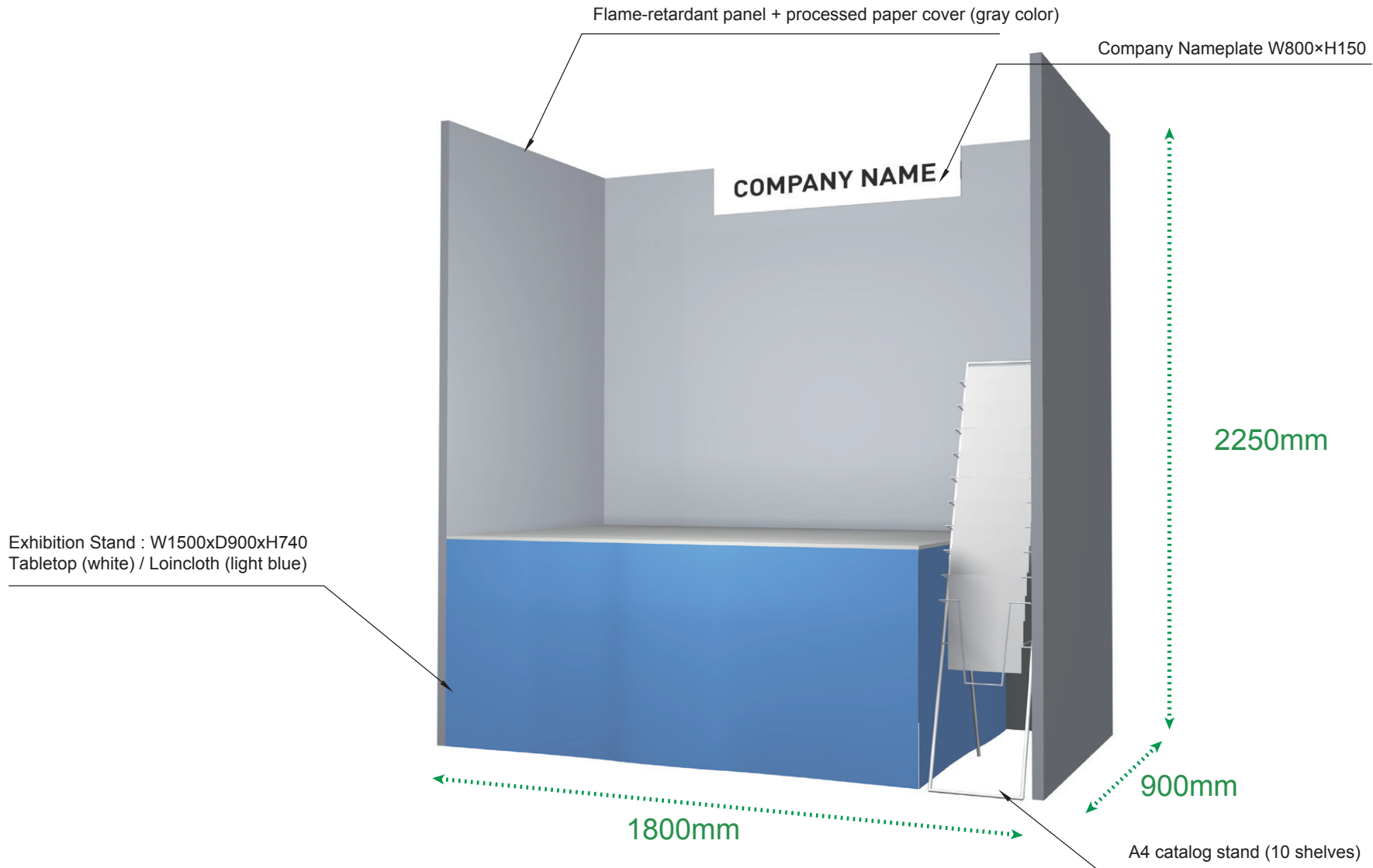

*This plan is limited to exhibitors with one booth.

*The white cloth and loincloth are loaned items, so if they become soiled or damaged, we will charge you the actual cost. Also, please do not take them home without permission.

*As a general rule, side panels are not provided for corner booths (aisleside). Exhibitors who require side panels must fill in the box on the attached "Application Form for Electrical Works". We cannot accommodate requests on the day.

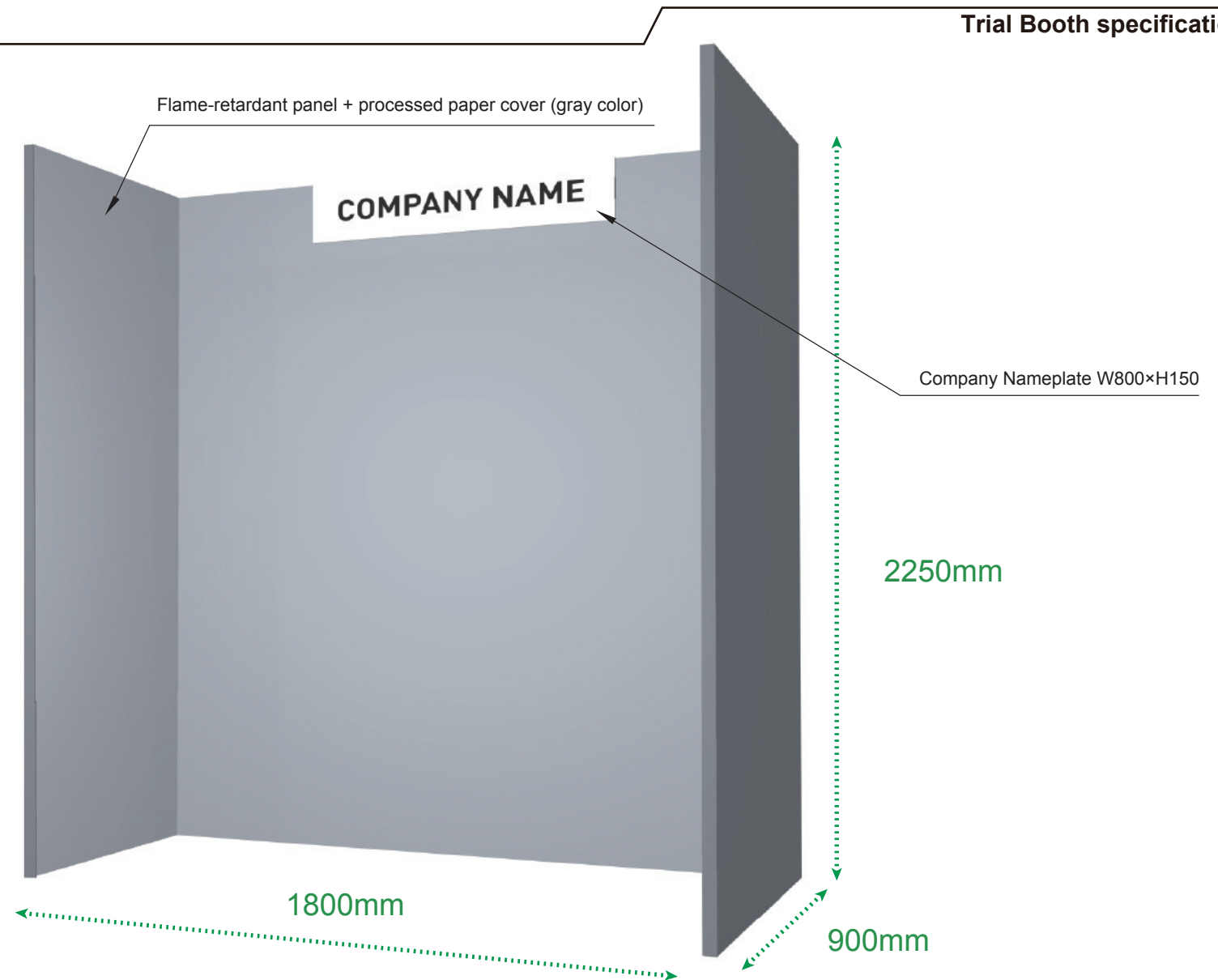

*Exhibition Stands and chairs are not included.

*You may bring in your own tables, display stands, etc., as long as they fit within the space. Rental (for a fee) is also available using the attached Application form for rental equipment.

*This plan is limited to exhibitors with one booth.

*As a general rule, side panels are not provided for corner booths (aisleside). Exhibitors who require side panels must fill in the box on the attached "Application Form for Electrical Works". We cannot accommodate requests on the day.

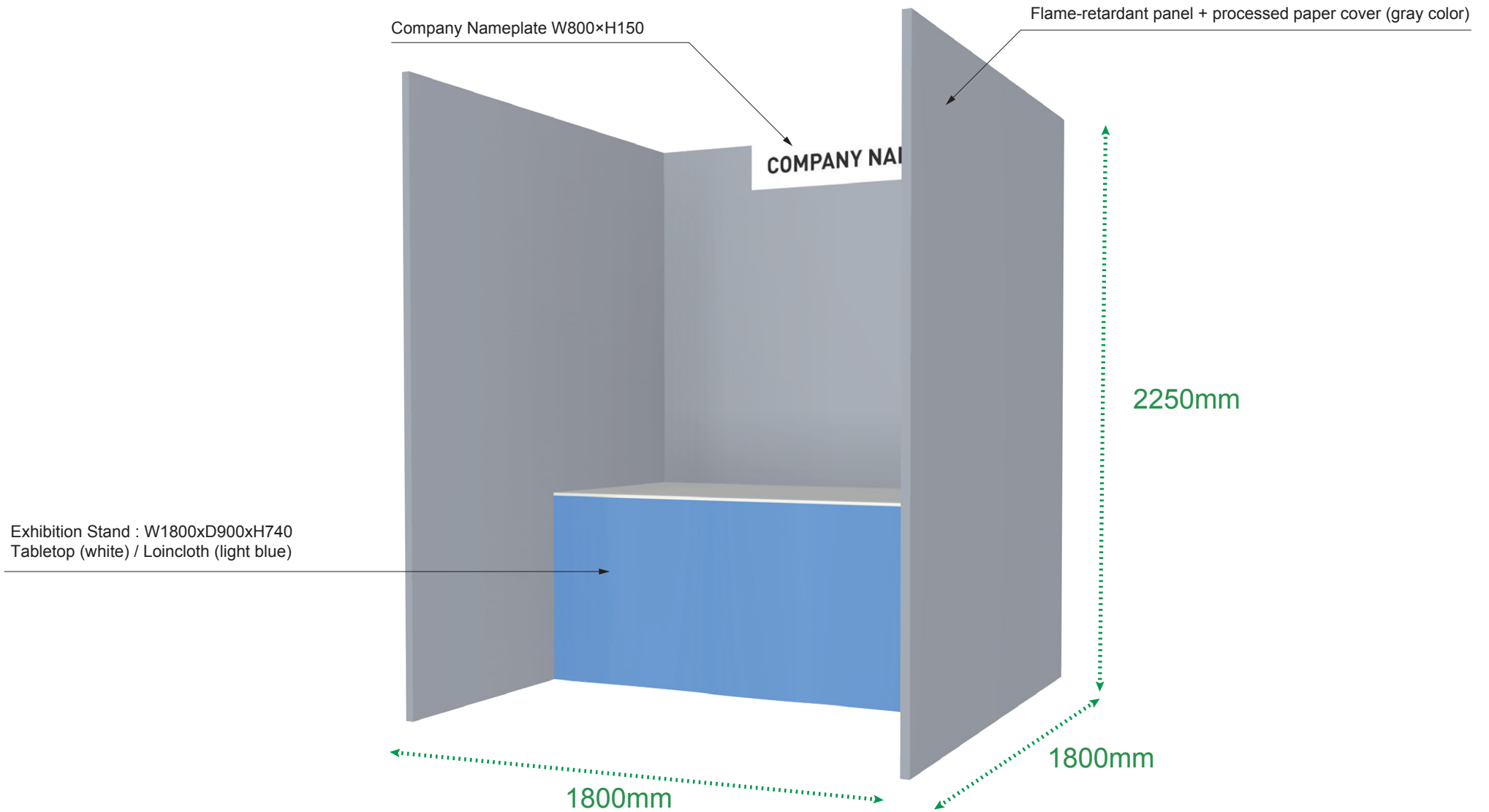

*If there are two or more booths, there will be no partition panels between them.

*The white cloth and loincloth are loaned items, so if they become soiled or damaged, we will charge you the actual cost . Also, please do not take them home without permission.

*The side panel cannot be removed from the Light Sources and Lighting Zone.

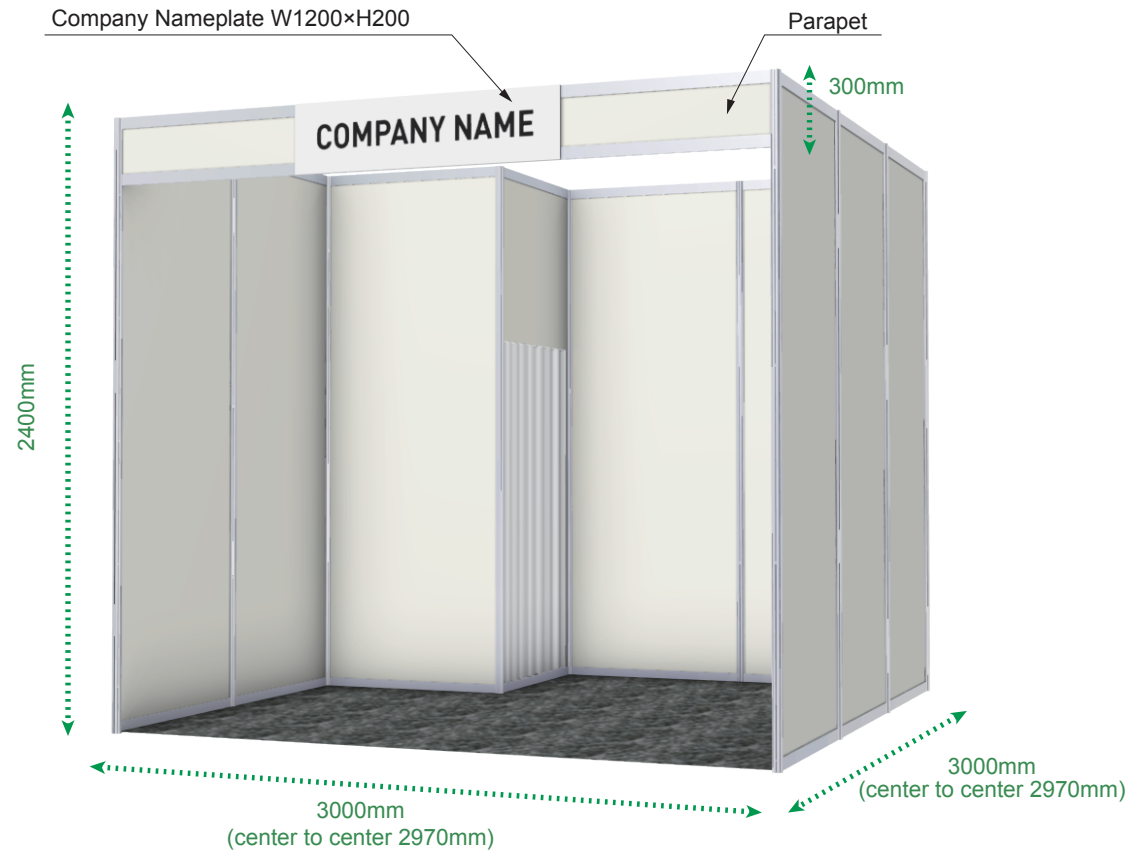
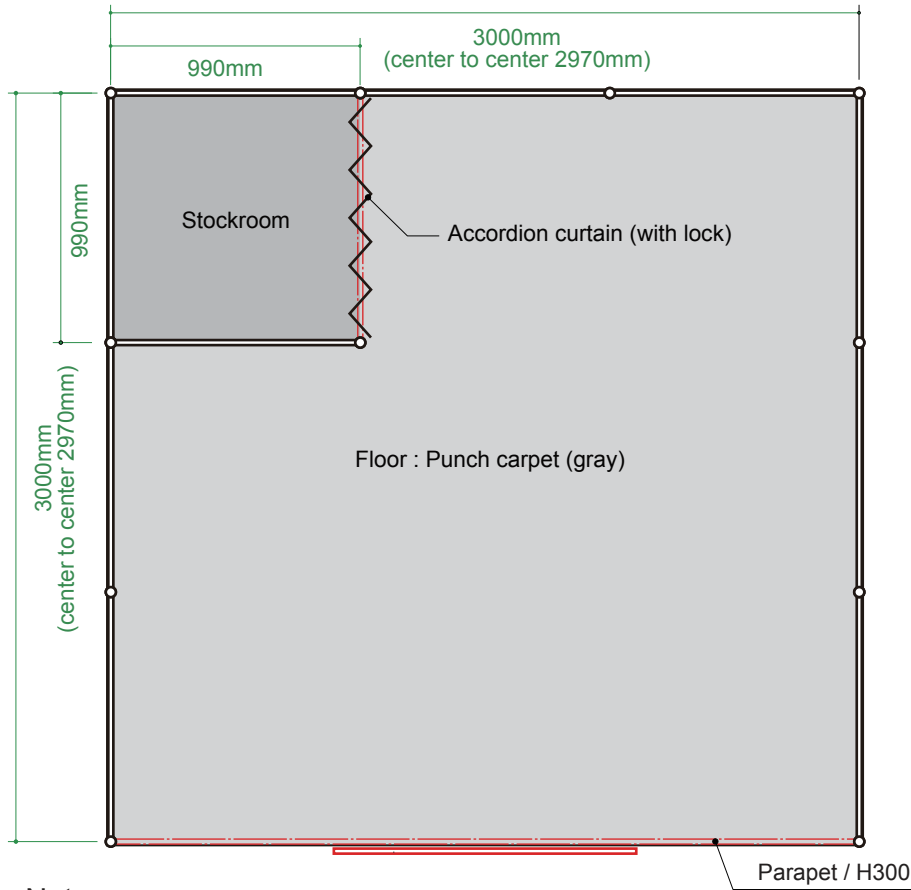

<Notes>

- 1.Package booths are made of system panels, so nails, screws, pins, thumb tacks, etc. cannot be driven into the walls (3mm thick). If the wall panels are damaged, we will charge you the actual cost. (¥11,000 (tax included) per panel) If you wish to apply a mounting to the wall, please erect a separate wooden panel.
- 2.When attaching posters, panels, etc. to the wall, please use cellophane tape, Velcro, etc. When attaching heavy panels, products, etc., please attach them from above using chains or S-shaped pipes (charges apply).
- 3.Package booths do not include exhibition stands, chairs, etc. Please apply for these items from the equipment rental section.
- 4.Exhibitors using corner booths must indicate whether or not they require side panels in the check box on the attached "Application Form for Electrical Works".
- 5.Please indicate whether or not you require a parapet and a stock room in the check boxes on the attached "Application Form for Electrical Works".

*We cannot accommodate requests for 4 and 5 on the day.

*The video provided will be played in a loop.

*Staff cannot be present at all times.

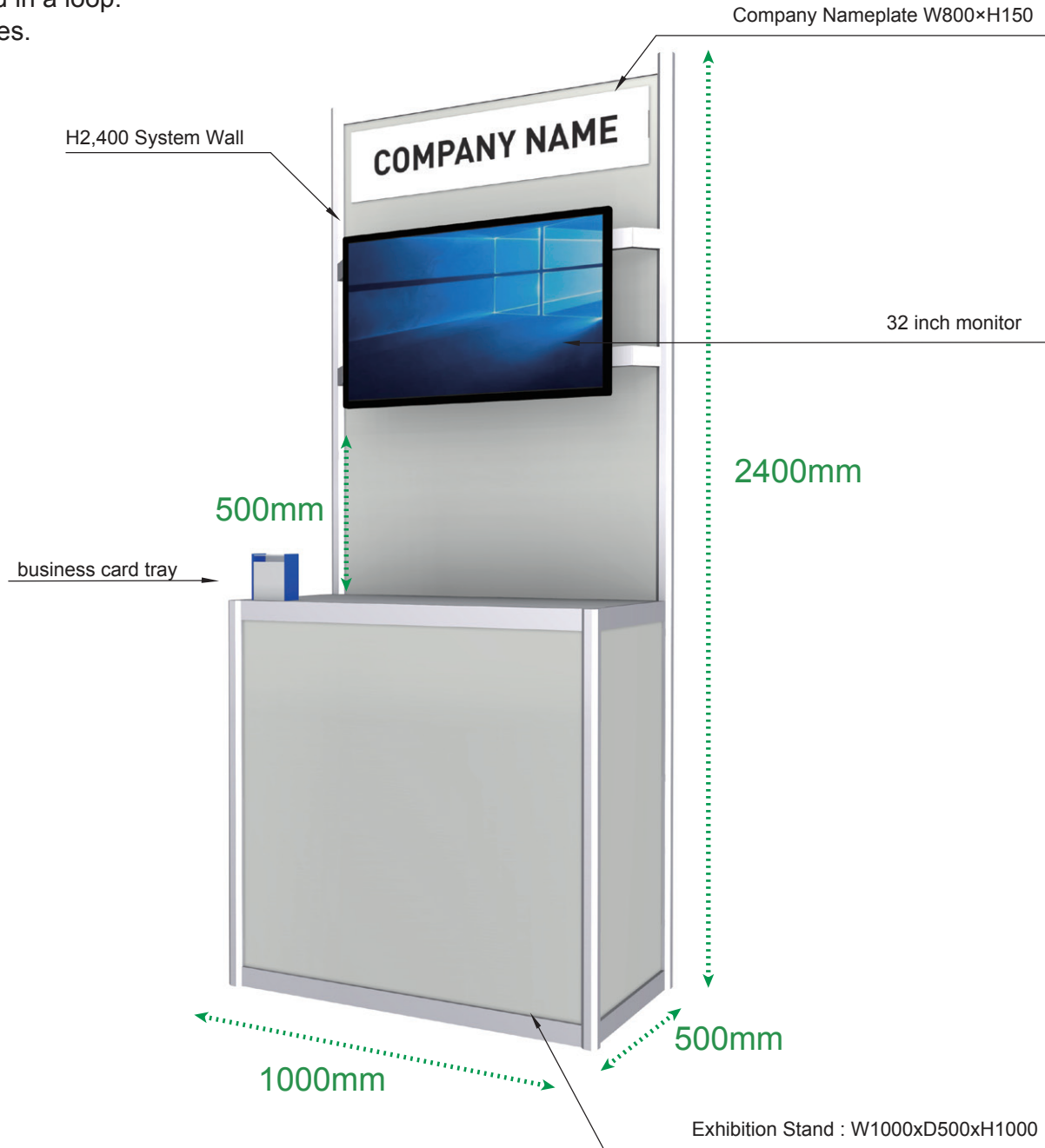

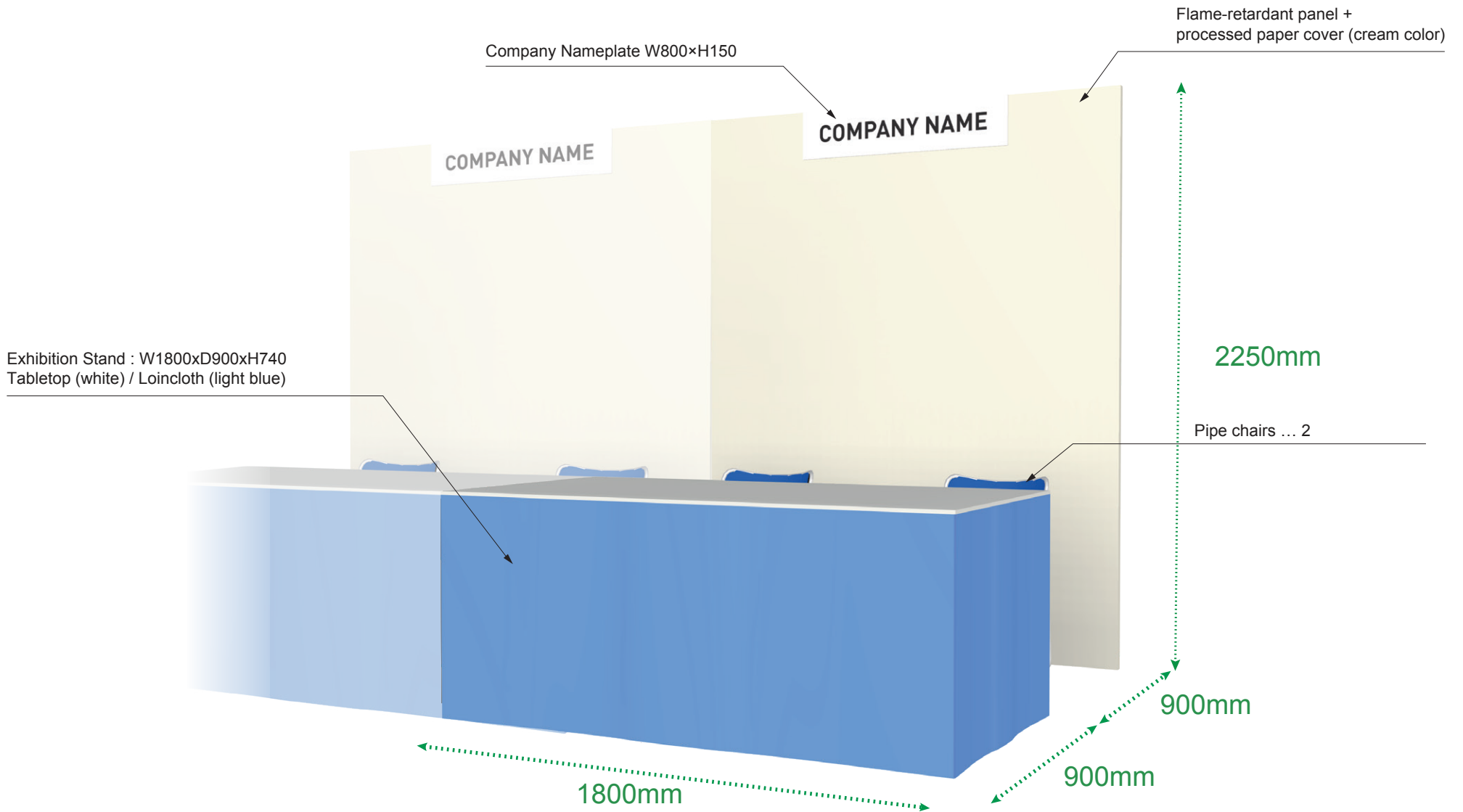

*There will be an aisle on either the left or right side of the booth.

*The white cloth and loincloth are loaned items, so if they become soiled or damaged, we will charge you the actual cost . Also, please do not take them home without permission.